

MDC MODEL 101-C SINGLE CABLESPHERE

MOLDED RUBBER EXPANSION JOINTS

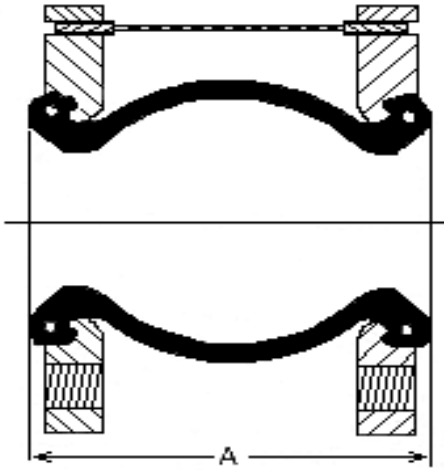

MATERIALS OF CONSTRUCTION	
FLANGES	Carbon Steel - Zinc Plated, 150#
REINFORCING WIRE	Mild Steel
TUBE & COVER	Neoprene
CABLE	Galv. Steel Aircraft Cable
REINFORCING CORD	Nylon

FEATURES:

- * Applicable for suction and discharge.
- * Provides sound and vibration isolation.
- * Gaskets and packing are not required.
- * Floating flanges allow for easy installation.
- * Prevents piping system and equipment breakdown by absorbing elongation and contraction caused by temperature variances.
- * Absorbs water pulsation and minimizes water hammering.

QTY	MDC P/N	SIZE (IN.)	FACE TO FACE "A" (IN.)	AXIAL COMP (IN.)	AXIAL EXT (IN.)	LATERAL +/- (IN.)	ANGULAR +/- DEG	THREAD SIZE	WEIGHT (LBS.)
	2.00"101-C	2"	6"	1/2"	3/8"	1/2"	15	5/8-11NC	8
	2.50"101-C	2-1/2"	6"	1/2"	3/8"	1/2"	15	5/8-11NC	13
	3.00"101-C	3"	6"	1/2"	3/8"	1/2"	15	5/8-11NC	14
	4.00"101-C	4"	6"	5/8"	3/8"	1/2"	15	5/8-11NC	18
	5.00"101-C	5"	6"	5/8"	3/8"	1/2"	15	3/4-10NC	23
	6.00"101-C	6"	6"	5/8"	3/8"	1/2"	15	3/4-10NC	28
	8.00"101-C	8"	6"	5/8"	1/2"	1/2"	15	3/4-10NC	40
	10.00"101-C	10"	8"	3/4"	1/2"	3/4"	15	7/8-9NC	68
	12.00"101-C	12"	8"	3/4"	1/2"	3/4"	15	7/8-9NC	96

OPERATING CONDITIONS:

SIZE RANGE	2" to 12"
Operating Pressure	225 psig
Maximum Operating Temperature	240 deg F
Vacuum Range	16 in Hg
Burst Pressure	900 psig

INSTALLATION TOLERANCES:

Compression:	3/16"
Extension:	1/8"
Lateral:	1/4"
Angular:	5 deg.
Not intended for torsion.	

NOTES:

- * Warning: Do not extend rubber expansion joints when installed in vacuum (suction) applications.
- * Cables are designed to allow full extension of the joint. Cables require no adjustment and should not be removed.
- * **Suitable for systems where proper guiding and anchoring might not be possible or verifiable.**

APPLICATIONS:

- * **Allows direct mounting on pumps where standard control units could interfere with the pump casing.**
- * Pumps and air compressors in A/C and sanitary equipment.
- * Refrigeration systems and blowers in industrial plant equipment.
- * Feed-water and drainage equipment in marine piping systems.
- * Applicable for use in power generation and chemical plants.

CUSTOMER	
PROJECT	
ENGINEER	
CUSTOMER REF.	
MDC REF.	
	20712
	2004-09-17
MDC DWG. NO.	JMP



MARK DAVID CANADA INC.

2011 Lucien Thimens
 Montreal, QC., H4R 1K8, Canada
 Tel.: (514) 748-8770, Fax: (514) 313-5697