

# MDC MODEL 102-U DOUBLE SPHERE UNION

## MOLDED RUBBER EXPANSION JOINTS

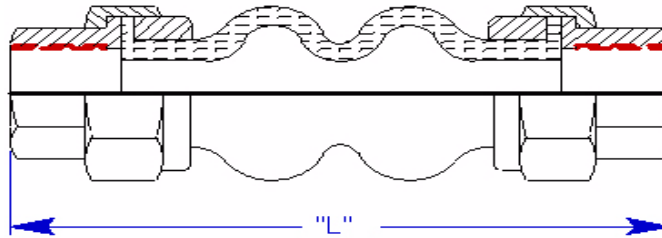

### MATERIALS OF CONSTRUCTION

UNIONS	Ductile Iron, Fem. NPT 150#
TUBE	Synthetic Rubber
COVER	Synthetic Rubber
REINFORCING CORD	Synthetic Fiber
REINFORCING WIRE	Mild Steel

### FEATURES

- \* Efficient noise and vibration isolation.
- \* Ability to absorb large displacement due to eccentric, axial and angular movement.
- \* Suitable for both suction and discharge.
- \* Unions allow for easy installation.

QTY	MDC P/N	SIZE (IN.)	OVERALL LENGTH "L" (IN.)	AXIAL COMP (IN.)	AXIAL EXT (IN.)	LATERAL +/- (IN.)	ANGULAR +/- DEG	NOTES
	0.50"-102-U	1/2"	7.95"	0.86"	0.23"	0.86"	30	
	0.75"-102-U	3/4"	7.95"	0.86"	0.23"	0.86"	30	
	1.00"-102-U	1"	7.95"	0.86"	0.23"	0.86"	25	
	1.25"-102-U	1-1/4"	7.95"	0.86"	0.23"	0.86"	25	
	1.50"-102-U	1-1/2"	7.95"	0.86"	0.23"	0.86"	20	
	2.00"-102-U	2	7.95"	0.86"	0.23"	0.86"	20	

### OPERATING CONDITIONS:

Operating Pressure	150 psig
Normal Operating Temperature	14 to 211 F
Vacuum Range	16"Hg
Burst Pressure	710 psig

### INSTALLATION TOLERANCES:

Compression:	0.50"-1.00": 0.16", 1.25"-2.00": 0.24"
Extension:	0.50"-2.00": 0.12"
Lateral:	0.50"-1.00": 0.24", 1.25"-1.50": 0.31" 2.00": 0.39"
Angular:	0.50"-2.00": 10 deg.

### NOTES:

- \* Warning: Do not extend rubber expansion joints when installed in vacuum (suction) applications.

### APPLICATIONS:

- \* Vibration isolation for small pumps and circular pumps.
- \* Sewage disposal purifier lines.
- \* Vibration isolation for air conditioners and pipes.

**NOT INTENDED FOR TORSION**

CUSTOMER (COMPANY)	
CUSTOMER (INDIVIDUAL)	
CUSTOMER TEL / FAX	
PROJECT	
ENGINEERING COMPANY	
CUSTOMER REFERENCE	
MDC REFERENCE NO.	
MDC DWG. NO.	20703

2008-01-03

JMP



**MARK DAVID CANADA**  
**MARK DAVID CANADA INC.**

2011 Lucien Thimens  
Montreal, QC., H4R 1K8, Canada  
TEL.: (514) 748-8770, FAX: (514) 313-5697