

MDC/RAILMEX MODEL **BSP** STAINLESS STEEL BRAIDED FLEXIBLE HOSE / PUMP CONNECTOR

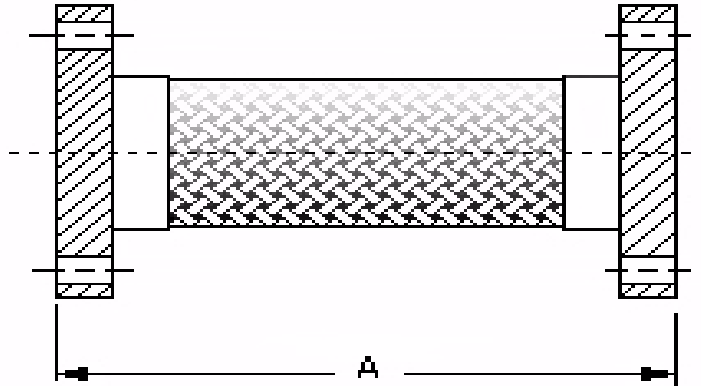

MATERIALS OF CONSTRUCTION

HOSE	300 Series Stainless Steel
BRAID	300 Series Stainless Steel
COLLAR	300 Series Stainless Steel
FLANGES	Carbon Steel, Class 150 (ANSI B16.5 Drilling), Flat Face

AVAILABLE ACCESSORIES / FEATURES :

- * Tie Rods
- * Smooth Flow Liner
- * External Guard
- * Double Braided
- * Jacketed Assembly
- * Longer Lengths, Other Fittings

QTY	MDC P/N	SIZE (IN.)	OVERALL LENGTH "A"	WORKING PRESSURE *		FLANGE THICKNESS	APPROX. WEIGHT (LBS)	NOTES
				AT 70 F (PSIG)	AT 250 F (PSIG)			
	2.00"BSP-9.00"	2"	9"	300	276	5/8"	11	
	2.50"BSP-9.00"	2-1/2"	9"	350	322	5/8"	14	
	3.00"BSP-9.00"	3"	9"	300	276	5/8"	15	
	4.00"BSP-9.00"	4"	9"	250	230	5/8"	20	
	5.00"BSP-11.00"	5"	11"	175	161	3/4"	28	
	6.00"BSP-11.00"	6"	11"	165	152	3/4"	33	
	8.00"BSP-12.00"	8"	12"	174	160	1"	52	
	10.00"BSP-13.00"	10"	13"	180	165	1"	74	

NOTES:

- * Lengths shown are minimum for vibration.
- * Braided hose assemblies are designed for vibration, lateral and angular deflection. Torsion and axial movement not allowed
- * For specific offset values contact MDC to determine adequate face to face dimension.
- * Available : assemblies with ISO 10380 Certified (50,000 life cycles) hose.
- * For elevated temperature service (above 250 F) please contact MDC for actual working pressure ratings.
- * Working pressure ratings may vary on specific application. Above pressure ratings are based on simple pump vibration in a static installation. For other applications, contact MDC.
- * CRN # OD2524.5234670189

CUSTOMER (COMPANY)	
CUSTOMER (INDIVIDUAL)	
CUSTOMER TEL / FAX	
PROJECT	
ENGINEERING COMPANY	
CUSTOMER REF.	
MDC REF.	
MDC DWG. NO.	20706
	2008-02-12 JMP



MARK DAVID CANADA INC.
 2011 Lucien Thimens
 Montreal, QC., H4R 1K8, Canada
 TEL.: (514) 748-8770, FAX: (514) 313-5697